

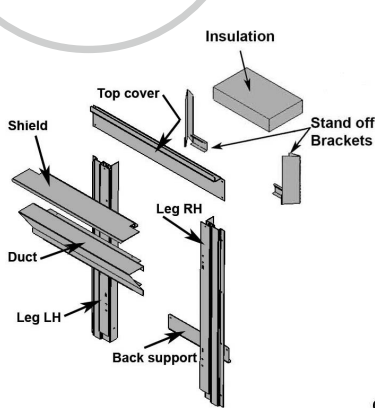

Model SFMK01 StoneFire Mantel Framing Kit For use with 530 Model Heater

May 06



Kit Components

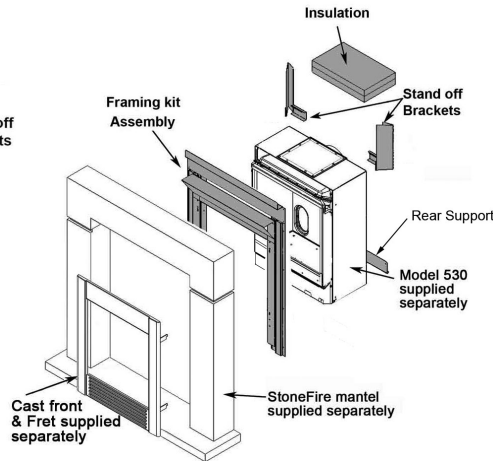

General Concept

Measure from finished floor height if hearth is to sit on top of finished floor.

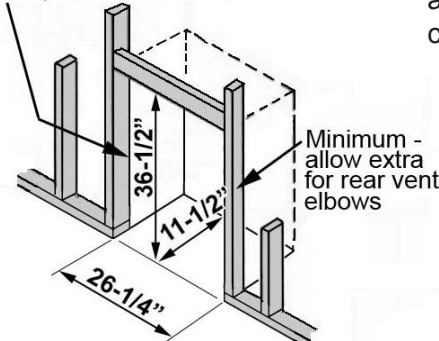

Framing Dimensions

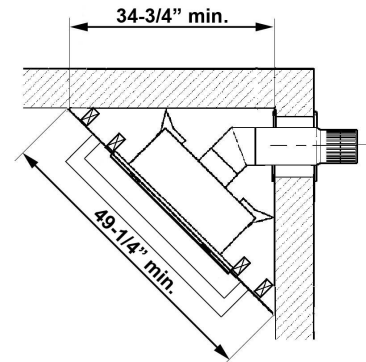

Corner Dimensions

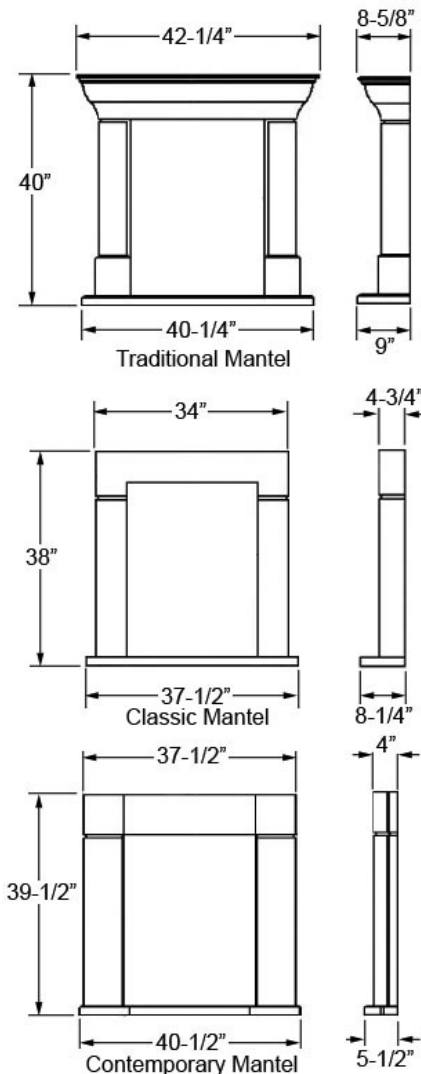

Mantel Choices

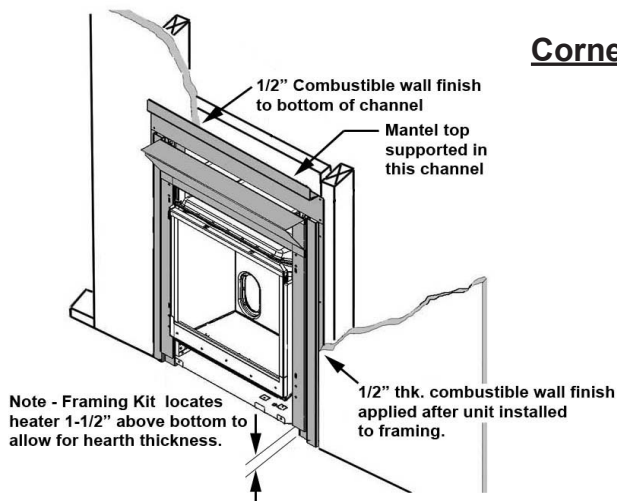

Wall Finish Details

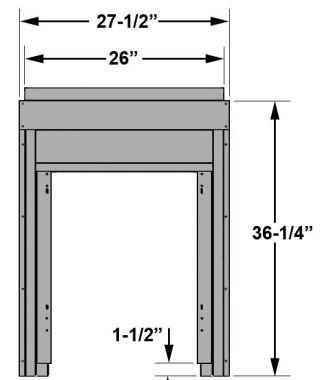

Framing Kit Dimensions

- The SFMK01 StoneFire Mantel Framing Kit is required when installing one of the stone mantels shown below. If the StoneFire cast iron front is desired without the mantel, install the heater using the SFFK01 FreeStyle framing kit as an alternate (see separate instructions).
- The framing kit, with heater attached, installs directly to studs at the framing stage with combustible wall finish applied afterwards. The wall finish must be 1/2" thick to ensure the outer perimeter of the mantle meets the wall properly.
- The bottom of the framing kit is flush with the bottom of the 1-1/2" thick stone hearth —raise the framed opening and framing kit accordingly if the floor finish is to run beneath the hearth.
- The hearth, heater, and framing kit are approved for mounting directly on combustible flooring.